

ACROBAT SHALLOW PLENUM WOOD CEILING - INSTALLATION INSTRUCTIONS

**READ AND FOLLOW ALL SAFETY INSTRUCTIONS!
SAVE THESE INSTRUCTIONS AND DELIVER TO OWNER AFTER INSTALLATION.**

WARNING: RISK OF ELECTRIC SHOCK

- Before installation or servicing **DISCONNECT POWER BY SHUTTING OFF THE CIRCUIT** breakers both to the outlet box and to its associated wall switch.
- Installation and service of luminaires should be performed by a qualified licensed electrician in accordance with all local and National Electrical Codes.
- Do not install damaged product.
- Verify that supply voltage is correct by comparing it with the luminaire label information.
- All wiring connections should be capped with UL approved wire connectors.

WARNING: RISK OF INJURY

- Allow luminaire to cool before servicing.
- Follow all manufacturer's warning and restrictions for driver type, mounting locations, replacement and recycling.
- Wear safety glasses and gloves when installing, maintaining or servicing.
- Avoid direct eye exposure to the light source while it is on.

RISK OF PRODUCT DAMAGE

- Never connect components under load.
- Do not touch the yellow surface of the LED as it may damage the light engine.

WARNING: RISK OF FIRE

- Do not separate any other wires that may be in the box.
- Do not damage the insulation of existing wiring.
- In regular circumstances the **BLACK** wire will be the "Hot" lead and the **WHITE** wire will be the "Neutral" or "Common" lead. A **GREEN** or **BARE COPPER** wire is the "Ground." In older buildings, it is always good practice to reconfirm the polarity of the wiring.

TOOLS REQUIRED

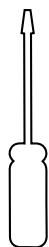

Flat Head
Screw Driver



Size 1 Phillips
Screw Driver

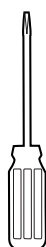

Size 2 Phillips
Screw Driver

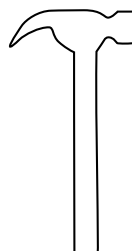

Claw Hammer

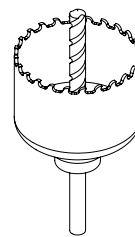

Hole Saw
(Or Speed Router)

ACCESSORIES REQUIRED



Electrical Wire Nut

APPLICABLE MODEL:

**Shallow Plenum New Construction IC Housing (SIC)
Shallow Plenum New Construction Housing (SNC)**

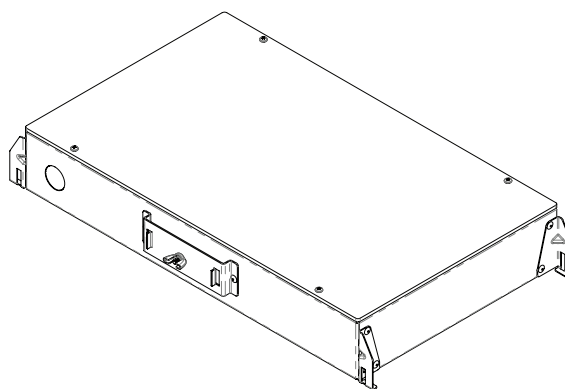

ACROBAT SHALLOW PLENUM WOOD CEILING - INSTALLATION INSTRUCTIONS

PREPARATION

Determine Housing Mounting Method

- **Standard Hanger Bars** provided secure the housing to ceiling joists or suspended ceiling frames (T-bars). Install the hanger bars in the frame slots, oriented as shown.
- **Butterfly Brackets** secure the housing using C-channel or conduit. To install the brackets, removed the wingnut and lock plate, mount the brackets on the housing, then re-attach the lock plate and wingnut. Adjust the vertical position of the housing by sliding the bracket up or down. Tighten the wingnut to lock the vertical position.

For All Applications: Remove Knock-Out(s)

Remove knock-out(s) where needed with a flat-head screwdriver and hammer.

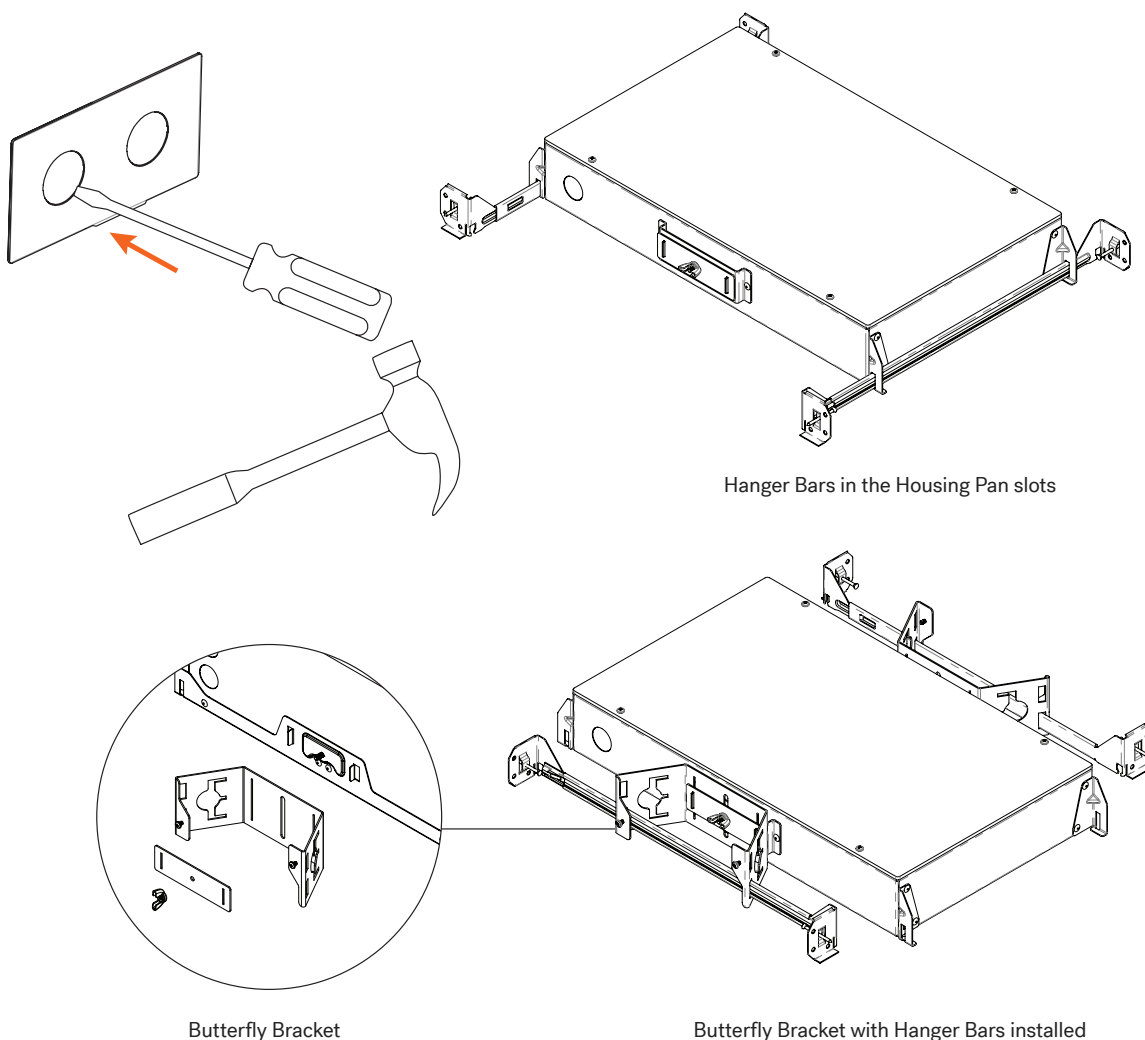

ACROBAT SHALLOW PLENUM WOOD CEILING - INSTALLATION INSTRUCTIONS

INSTALLATION

STEP 1 - Hanger Bars Adjustment

Adjust the hanger bars to fit between joists
(For suspended ceiling, remove the required tile).

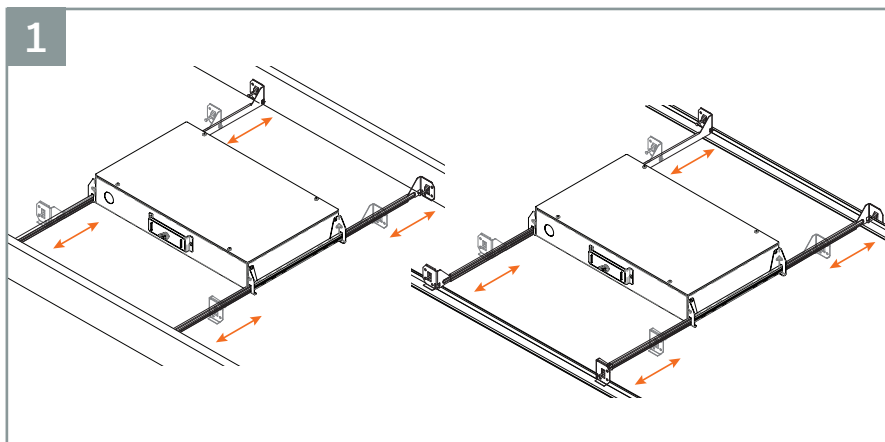

STEP 2 - Secure Hanger Bars

- For wood joists, Line up the bottom of the hanger bars to the bottom of the joists and nail the ends of the hanger bars to the joists.
- For suspended Ceiling (T-Bar), Snap the hanger bars in place on the suspended ceiling T-bar.

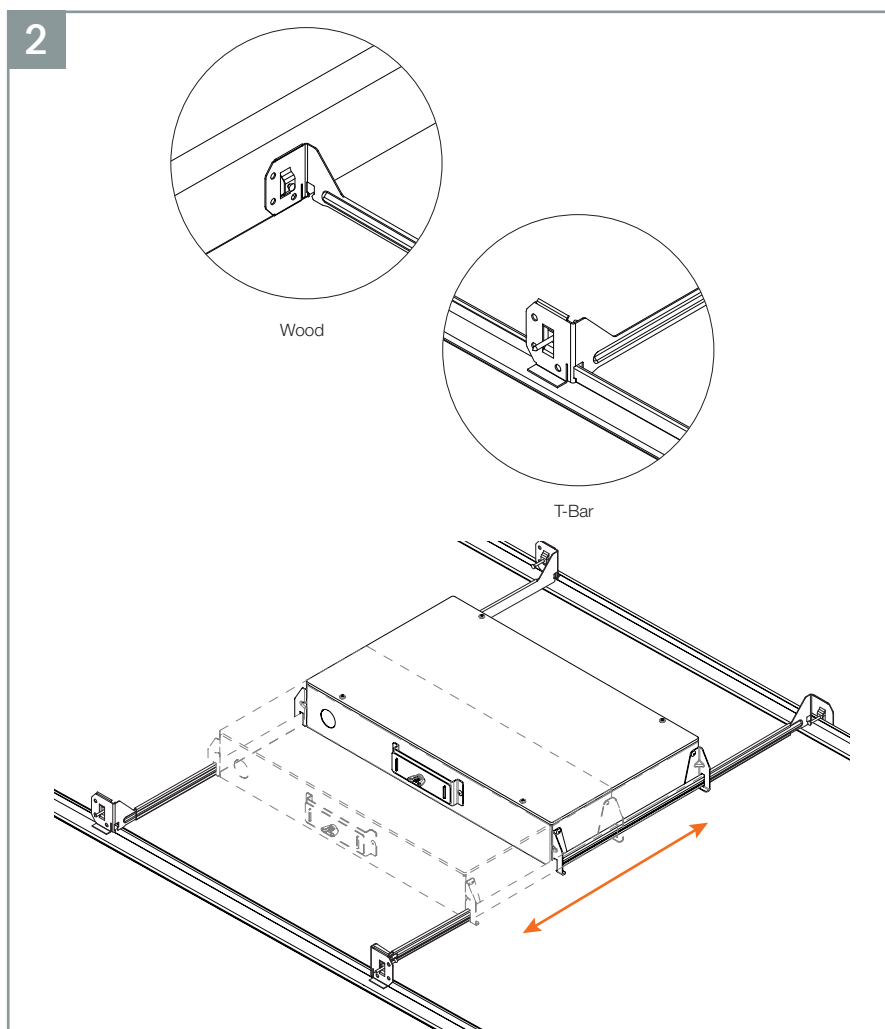

ACROBAT SHALLOW PLENUM WOOD CEILING - INSTALLATION INSTRUCTIONS

STEP 3 - Secure System

Slide the housing to the desired position and use a flat head screwdriver to tilt the locking tabs into the hanger bars until system is secure.

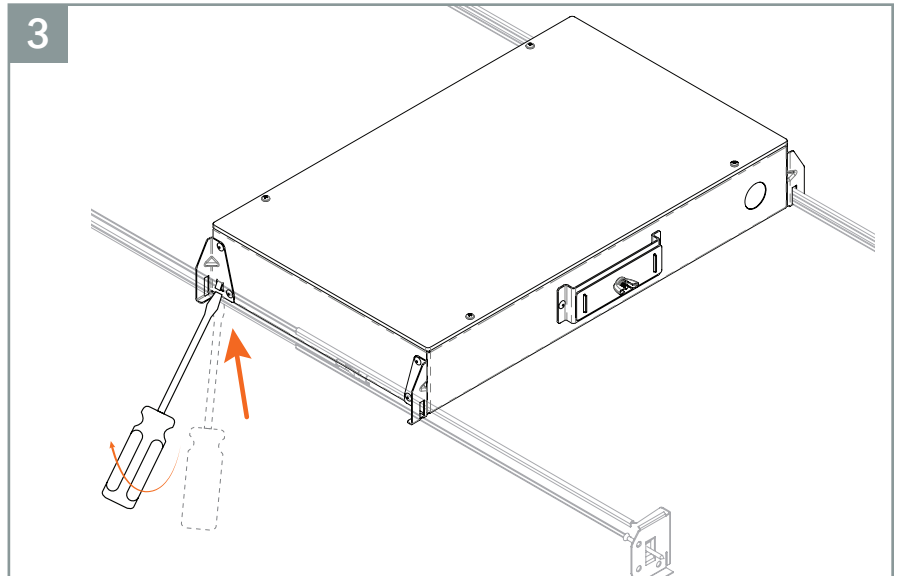

STEP 4 - Position Measurement

Measure and mark the location of the pan hole from wood joists/T-Bars.

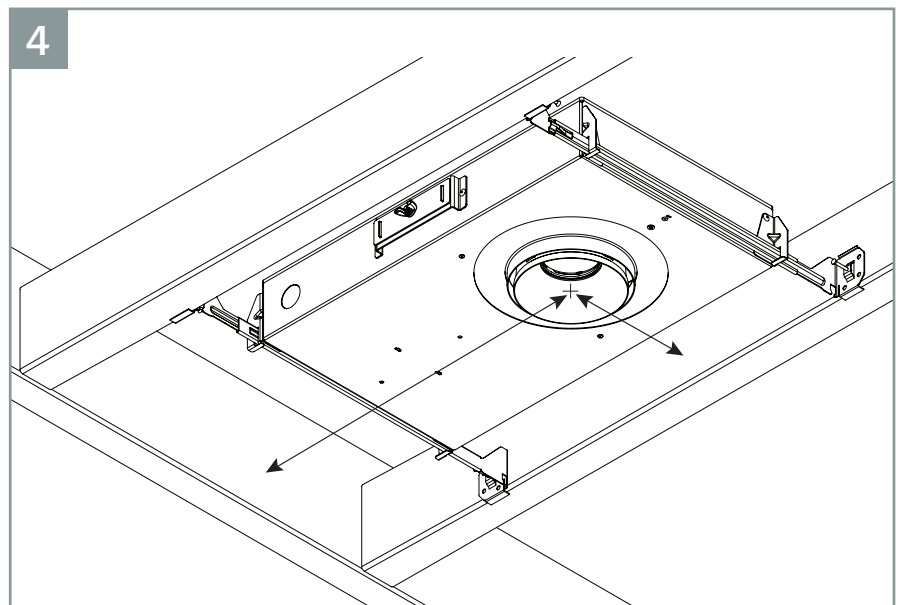

ACROBAT SHALLOW PLENUM WOOD CEILING - INSTALLATION INSTRUCTIONS

STEP 5A – Make Electrical Connection

- If not already completed, use a flathead screwdriver and hammer to punch out knock-out(s).
- Using a #1 Phillips screwdriver, remove access panel.
- Using a UL listed conduit connector secure connector to the knock-out opening, passing supply wires through connector.
- Connect supply wires using approved wire nuts to the Driver using the wiring diagrams shown.
- Reattach access panel.

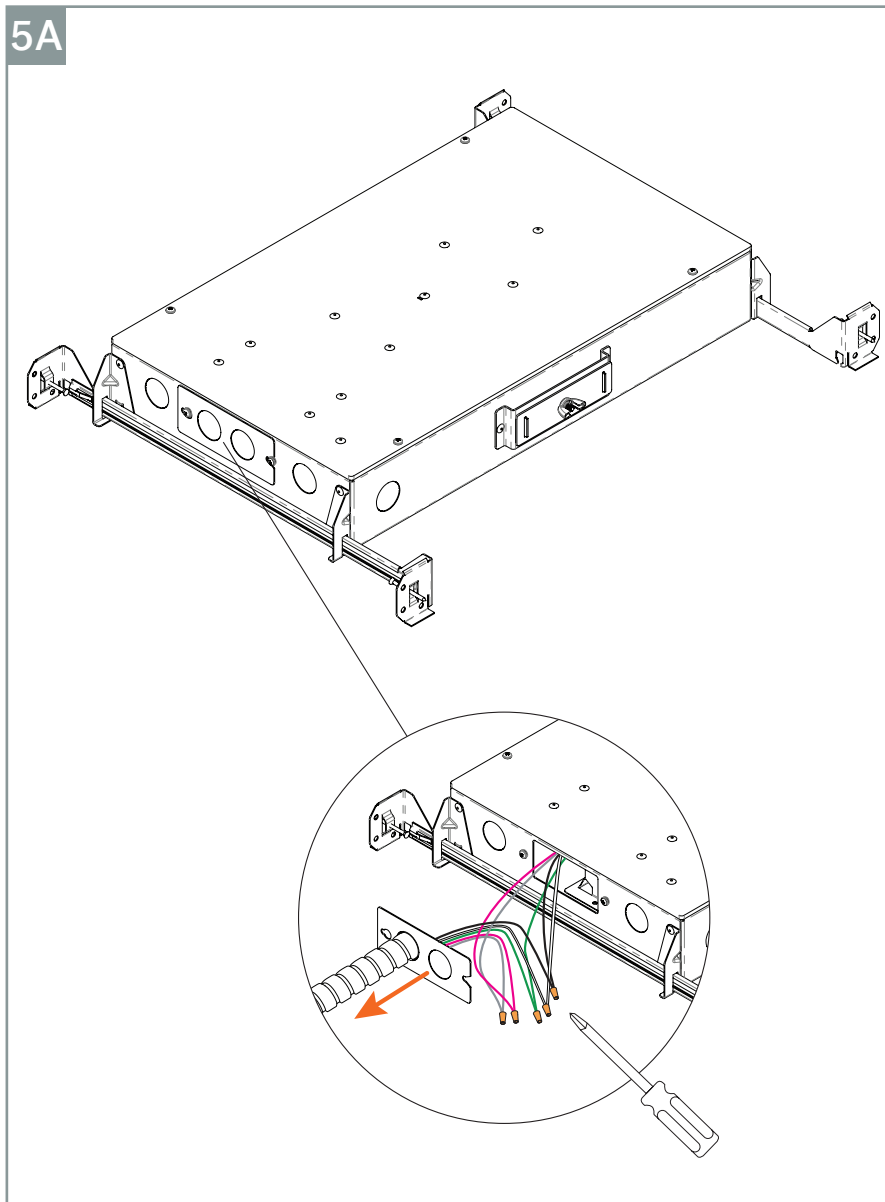

ACROBAT SHALLOW PLENUM WOOD CEILING - INSTALLATION INSTRUCTIONS

STEP 5B - Wiring Diagrams

5B

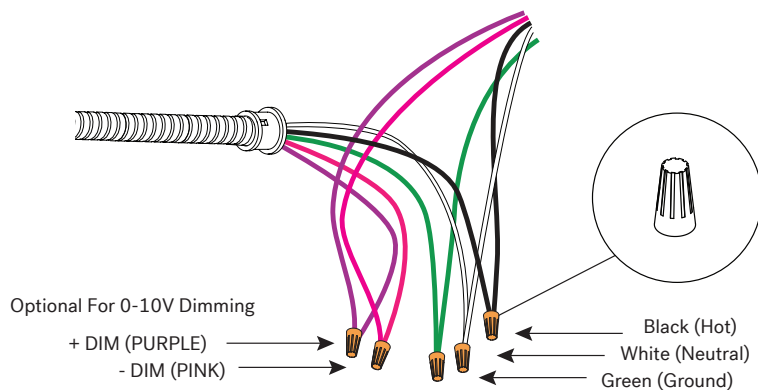

TRI-DIMMING

For Single-Block Connection

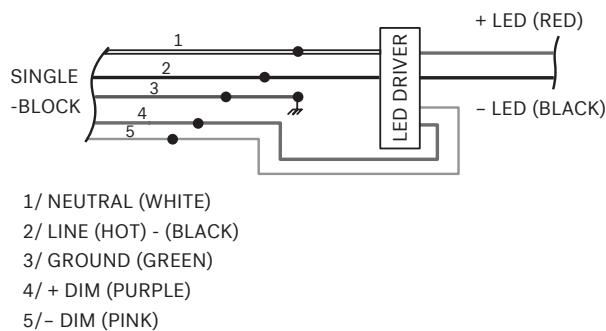

For Pass-Through Connection

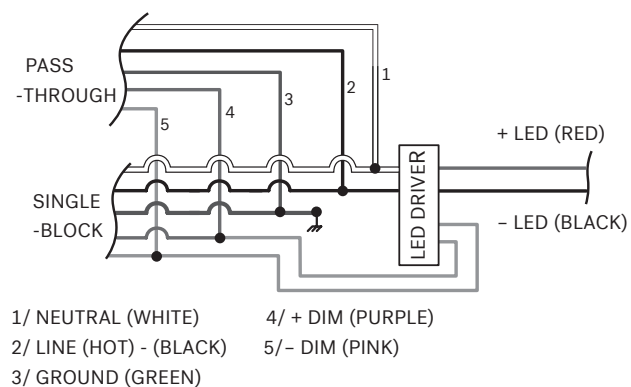

PHASE DIMMING ONLY

For Single-Block Connection

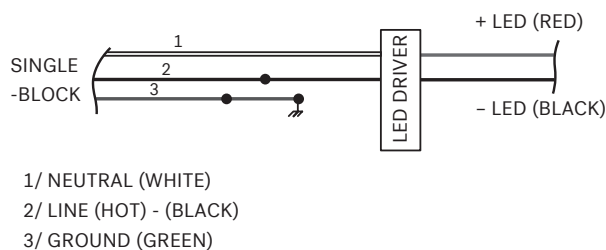

For Pass-Through Connection

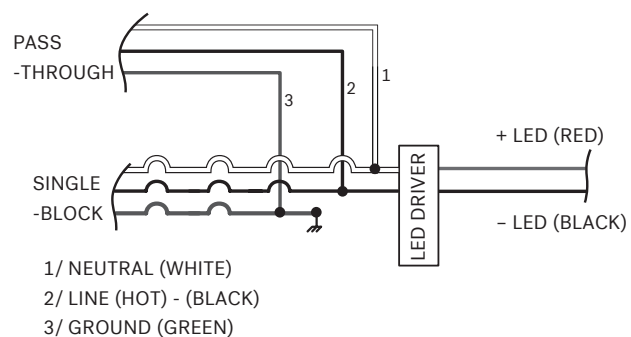

ACROBAT SHALLOW PLENUM WOOD CEILING - INSTALLATION INSTRUCTIONS

STEP 6A - Wood Ceiling Cutout + Installation

- Ceiling needs to be prepared with a larger hole cut above a smaller hole to create the trimless effect.
- One method is to cut the larger hole in the ceiling and the smaller hole in laminate and place the laminate over the hole on the ceiling.
- Another method is to cut the smaller hole and create the larger space above it using a router.
- Thickness of material around small Thru-Hole must be 1/4 Inch.

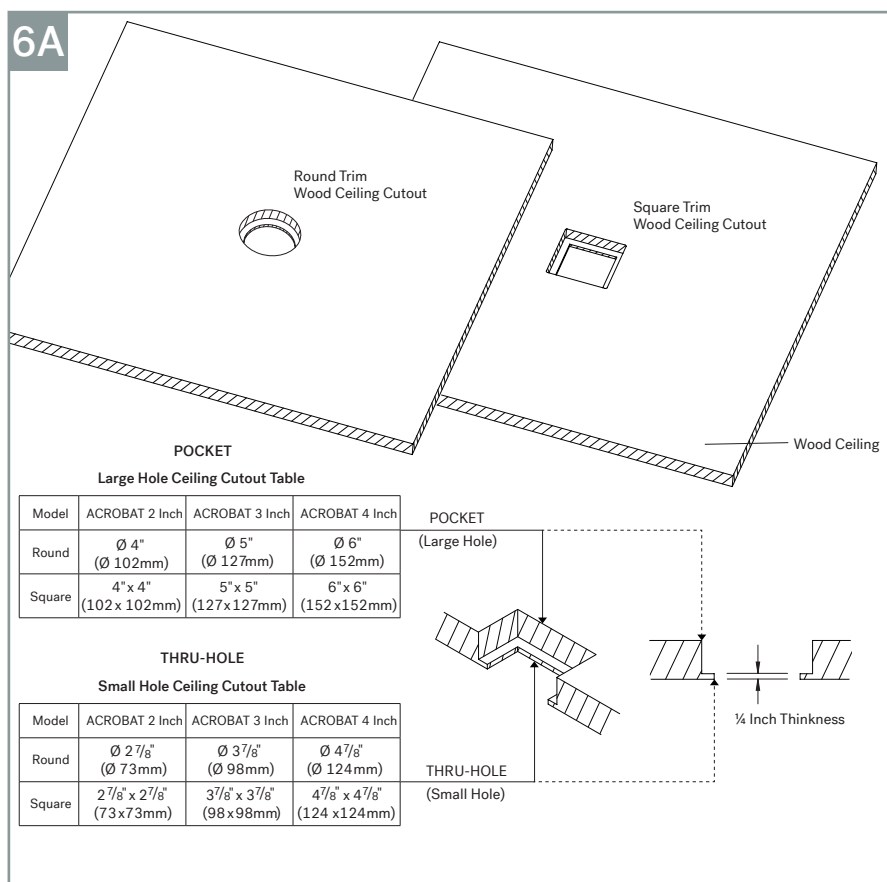

STEP 6B - Install Wood Ceiling Adapter into the Housing

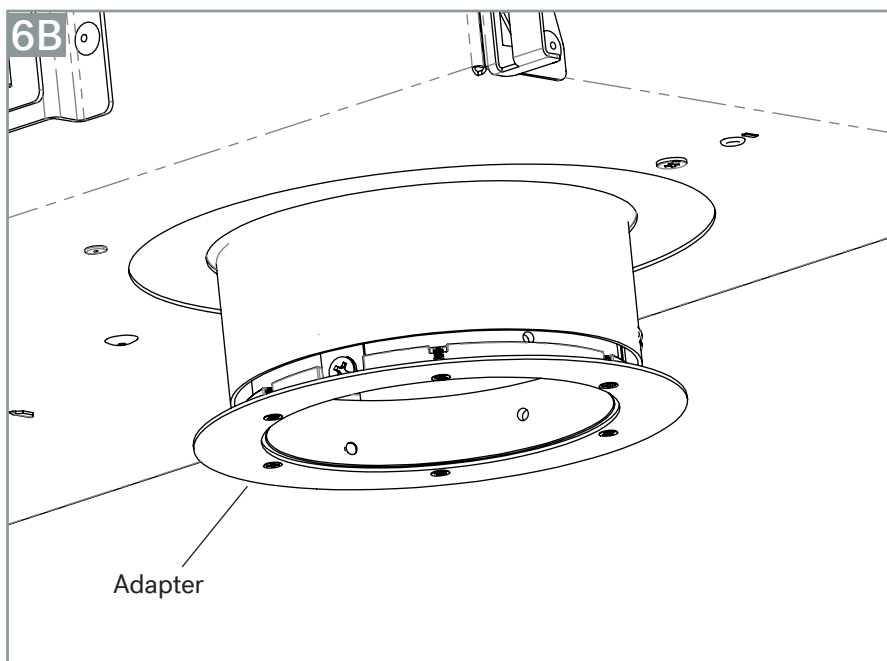

ACROBAT SHALLOW PLENUM WOOD CEILING - INSTALLATION INSTRUCTIONS

STEP 6C - Install Wood Ceiling

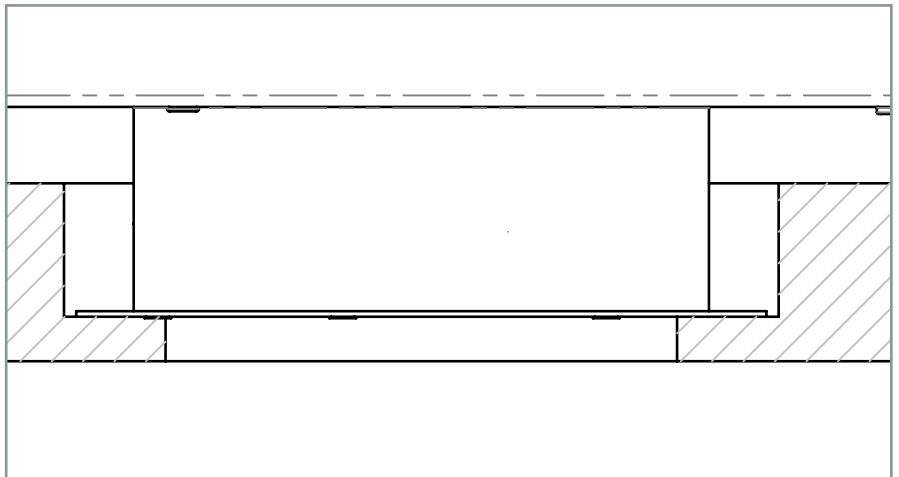
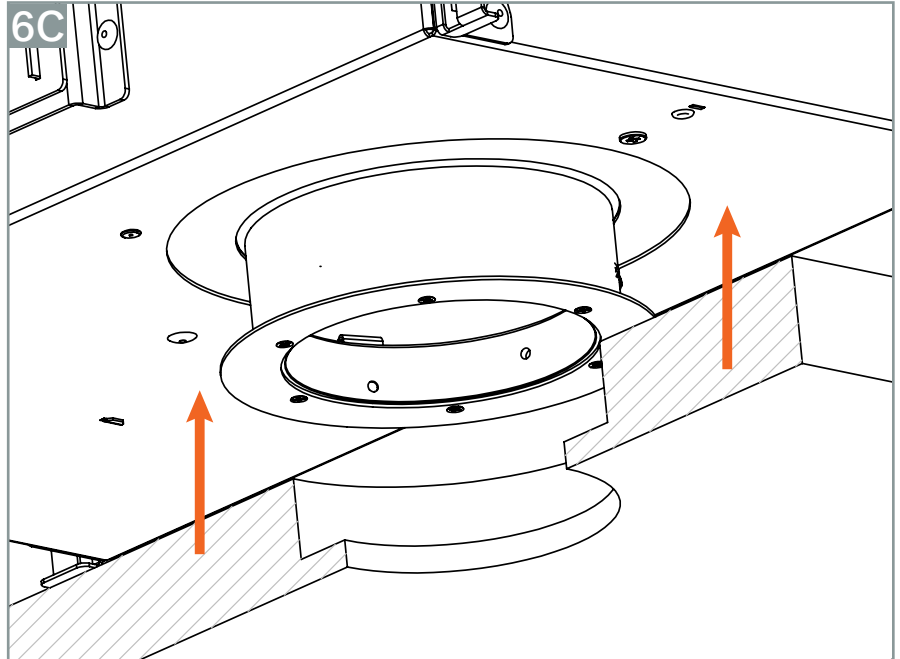

ACROBAT SHALLOW PLENUM WOOD CEILING - INSTALLATION INSTRUCTIONS

STEP 6D – Install Reflector into the Adaptor

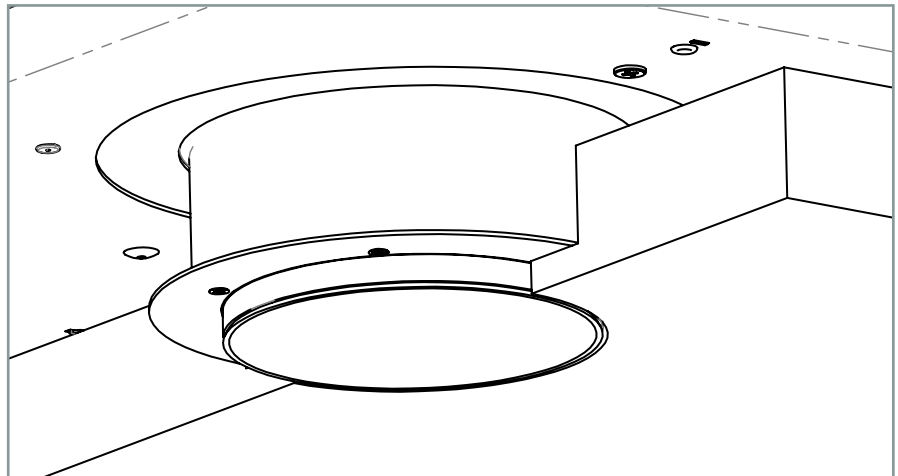
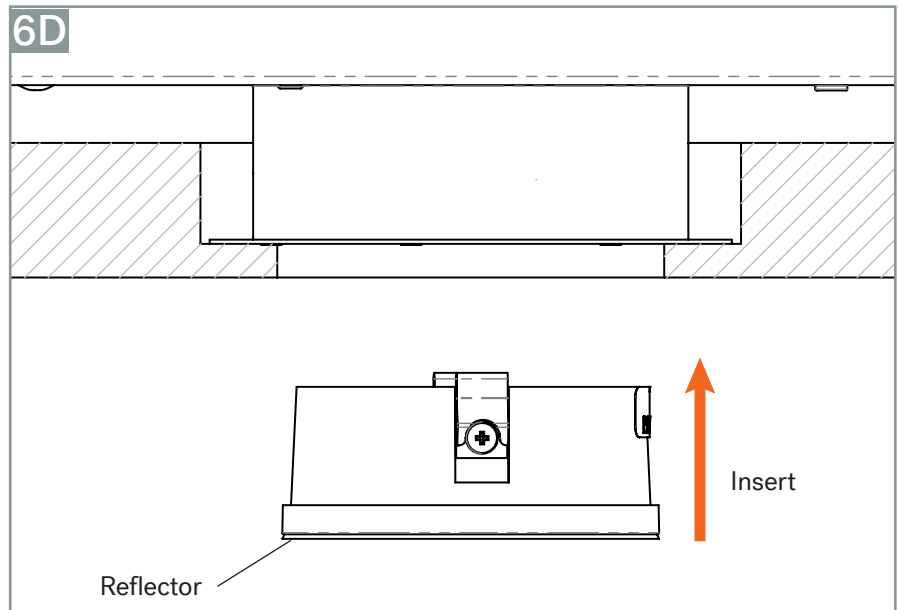

Round Trimless Shown



Square Trimless Shown